

Rozmieszczenie otworów kierunkowych z Chodnika Głównego 501/C badawczego (wnęka wiertnicza) w pokładzie 501/II w polu C na poziomie 900m

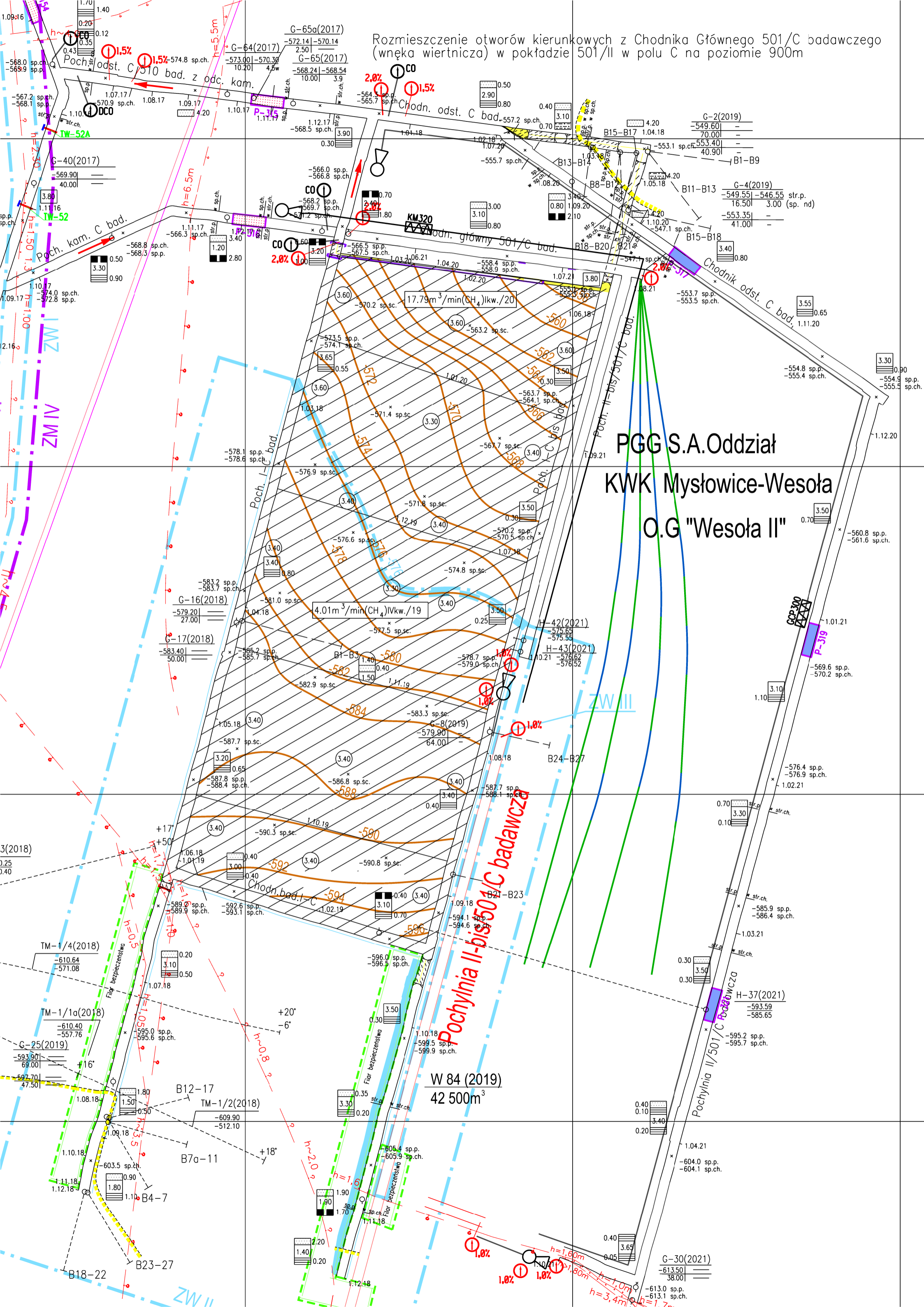

PGG S.A. Oddział  
KWK Mysłowice-Wesoła  
O.G "Wesoła II"

W 84 (2019)  
42 500m<sup>3</sup>

Pochylnia II-bis 501/C badawcza

Pochylnia II/501/C badawcza

TM-1/4(2018)

TM-1/1a(2018)

TM-1/2(2018)

B7a-11

B4-7

B18-22

B23-27

B12-17

B18-22

B23-27

B7a-11

B4-7

B12-17

B18-22

B23-27

B7a-11

B4-7

B12-17

B18-22

B23-27

B7a-11

B4-7

B12-17

B18-22

B23-27

B7a-11

B4-7

B12-17

B18-22

B23-27

B7a-11

B4-7

B12-17

B18-22

B23-27

B7a-11

B4-7

B12-17

B18-22

B23-27

B7a-11

B4-7

B12-17

B18-22

B23-27

B7a-11

B4-7

B12-17

B18-22

B23-27

B7a-11

B4-7

B12-17

B18-22

B23-27

B7a-11

B4-7

B12-17

B18-22

B23-27

B7a-11

B4-7

B12-17

B18-22

B23-27

B7a-11

B4-7

B12-17

B18-22

B23-27

B7a-11

B4-7

B12-17

B18-22

B23-27

B7a-11

B4-7

B12-17

B18-22

B23-27

B7a-11

B4-7

B12-17

B18-22

B23-27

B7a-11

B4-7

B12-17

B18-22

B23-27

B7a-11

B4-7

B12-17

B18-22

B23-27

B7a-11

B4-7

B12-17

B18-22

B23-27

B7a-11

B4-7

B12-17

B18-22

B23-27

B7a-11

B4-7

B12-17

B18-22

B23-27

B7a-11

B4-7

B12-17

B18-22

B23-27

B7a-11

B4-7

B12-17

B18-22

B23-27

B7a-11

B4-7

B12-17

B18-22

B23-27

B7a-11

B4-7

B12-17

B18-22

B23-27

B7a-11

B4-7

B12-17

B18-22

B23-27

B7a-11

B4-7

B12-17

B18-22

B23-27

B7a-11

B4-7

B12-17

B18-22

B23-27

B7a-11

B4-7

B12-17

B18-22

B23-27

B7a-11

B4-7

B12-17

B18-22

B23-27

B7a-11

B4-7

B12-17

B18-22

B23-27

B7a-11

B4-7

B12-17

B18-22

B23-27

B7a-11

B4-7

B12-17

B18-22

B23-27

B7a-11

B4-7

B12-17

B18-22

B23-27

B7a-11

B4-7

B12-17

B18-22

B23-27

B7a-11

B4-7

B12-17

B18-22

B23-27

B7a-11

B4-7

B12-17

B18-22

B23-27

B7a-11

B4-7

B12-17

B18-22

B23-27

B7a-11

B4-7

B12-17

B18-22

B23-27

B7a-11

B4-7

B12-17

B18-22

B23-27

B7a-11

B4-7

B12-17

B18-22

B23-27

B7a-11

B4-7

B12-17

B18-22

B23-27

B7a-11

B4-7

B12-17

B18-22

B23-27

B7a-11

B4-7

B12-17

B18-22

B23-27

B7a-11

B4-7

B12-17

B18-22

B23-27

B7a-11

B4-7

B12-17

B18-22

B23-27

B7a-11

B4-7

B12-17

B18-22

B23-27

B7a-11

B4-7

B12-17

B18-22

B23-27

B7a-11

B4-7

B12-17

B18-22

B23-27

B7a-11

B4-7

B12-17

B18-22

B23-27

B7a-11

B4-7

B12-17

B18-22

B23-27

B7a-11

B4-7

B12-17

B18-22

B23-27

B7a-11

B4-7

B12-17

B18-22

B23-27

B7a-11

B4-7

B12-17

B18-22

B23-27

B7a-11

B4-7

B12-17

B18-22

B23-27

B7a-11

B4-7

B12-17

B18-22

B23-27

B7a-11

B4-7

B12-17

B18-22

B23-27

B7a-11

B4-7

B12-17

B18-22

B23-27

B7a-11

B4-7

B12-17

B18-22

B23-27

B7a-11

B4-7

B12-17

B18-22

B23-27

B7a-11

B4-7

B12-17

B18-22

B23-27

B7a-11

B4-7

B12-17

B18-22

B23-27

B7a-11

B4-7

B12-17

B18-22

B23-27

B7a-11

B4-7

B12-17

B18-22

B23-27

B7